

REVISIONS

NO.	DESCRIPTION	DATE
1	ISSUED FOR REVIEW	01/07/02
2	ISSUED FOR REVIEW	01/25/02
3	PRESENTATION	01/28/02
4	ISSUED FOR PERMIT	03/11/02
5	REVIEW COMMENTS	06/30/02
6	PHASE II REVIEW	11/11/02
7	PHASE II REVIEW	01/28/03
8	ISSUED FOR PERMIT	02/27/03

PROJECT

**FERRARI CARANO  
WINE CAVE**

8761 DRY CREEK ROAD  
HEALDSBURG, CA 95448

**CAVE  
POWER PLAN**

Ownership and Use of Documents:  
All Drawings, Specifications, Documents, and the ideas and designs incorporated herein, and copies thereof furnished by Don Magorian d.b.a. MAGORIAN MINE SERVICES are and shall remain the property of MAGORIAN MINE SERVICES. They are to be used only with respect to this project and shall not be used in whole or in part by any persons on other projects, or extensions to this project without expressed written agreement with MAGORIAN MINE SERVICES. The Drawings and Documents are protected by the Copyright Law "Work of the Visual Arts", Register of Copyrights, Library of Congress, Washington, DC 20559.

DATE 07/24/01

SCALE AS NOTED

JOB NO. 0106.01

SHEET NO.

**E1.0**

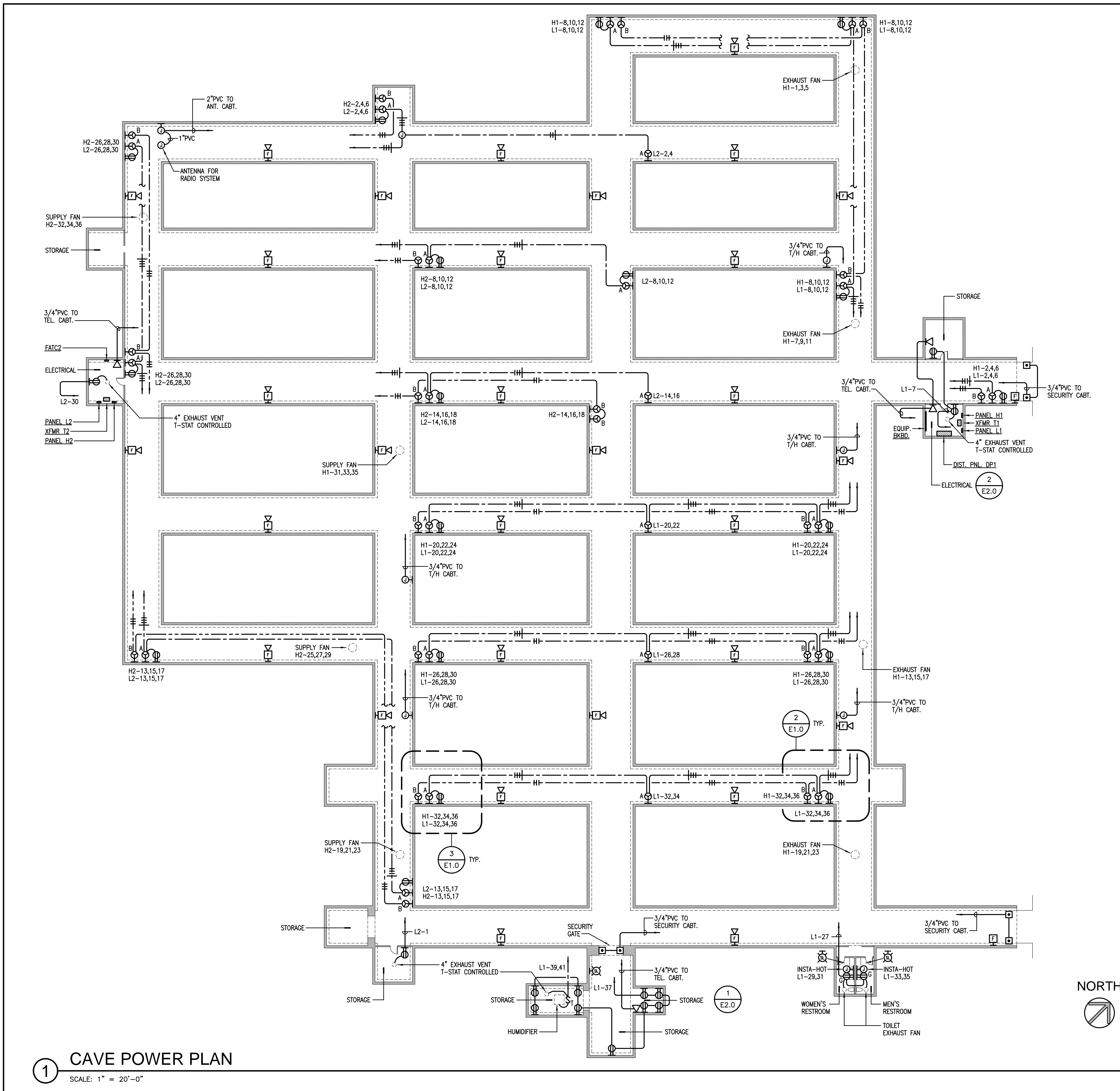

**LEGEND**

- 120V DUPLEX RECEPTACLE WITH WEATHERPROOF COVER
- 208V, 14, 20A SINGLE RECEPTACLE WITH WEATHERPROOF COVER
- 480V, 3φ, 30A SINGLE RECEPTACLE IN WEATHERPROOF HOUSING
- 208V CONDUIT SYSTEM WITH QUANTITY OF WIRES INDICATED
- 480V CONDUIT SYSTEM WITH QUANTITY OF WIRES INDICATED
- COMMUNICATIONS CONDUIT SYSTEM

**3** DETAIL AT OUTLETS

SCALE: NOT TO SCALE

**2** DETAIL AT OUTLETS

SCALE: NOT TO SCALE

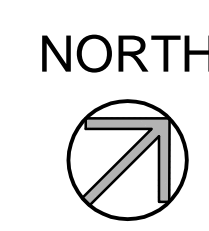
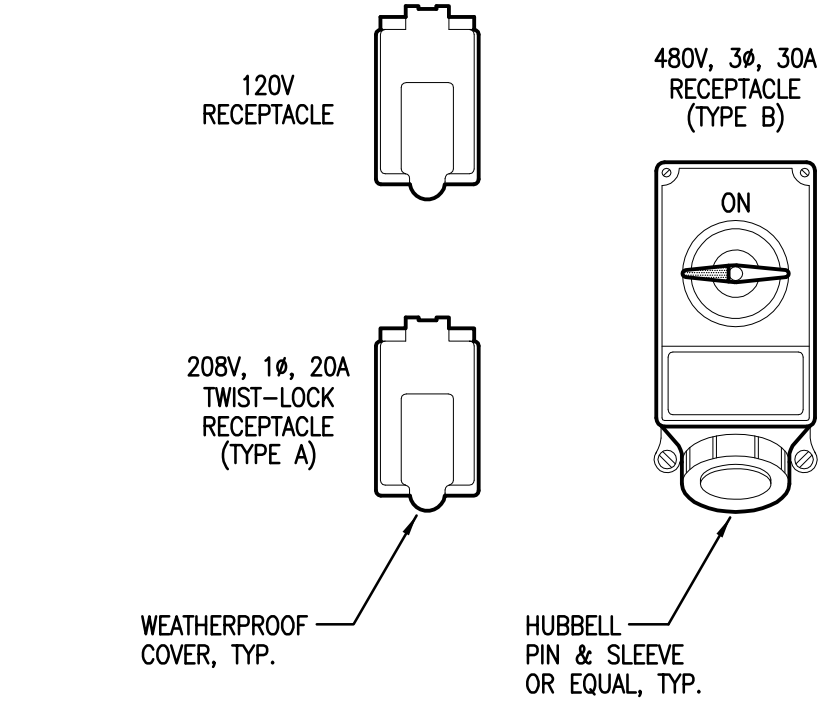
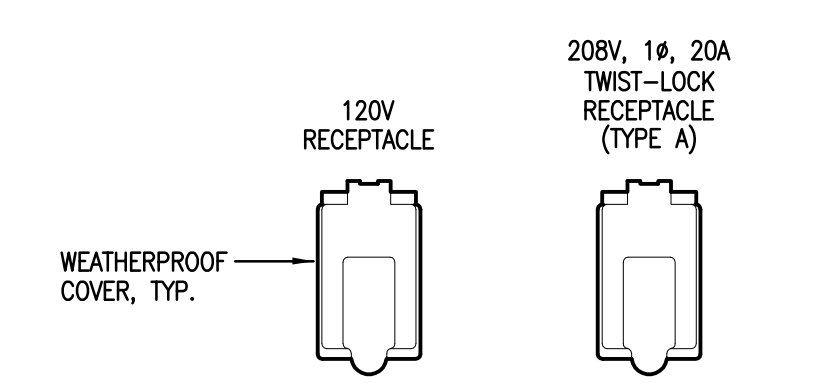

**1** CAVE POWER PLAN  
SCALE: 1" = 20'-0"